

Rhododendron Meeting Room

17'25" X 27' with 8' ceiling

Normal Set Up Casual Seating for 20 with 2 tables in back

Bulletin strips on one side & front walls
 Bulletin board on back wall
 6' Projection Screen hung front center only

Portable PA System Available
 CD/Tape Player/Recorder Available
 Maximum of 4 mikes / inputs

Other Set Up Equipment Available

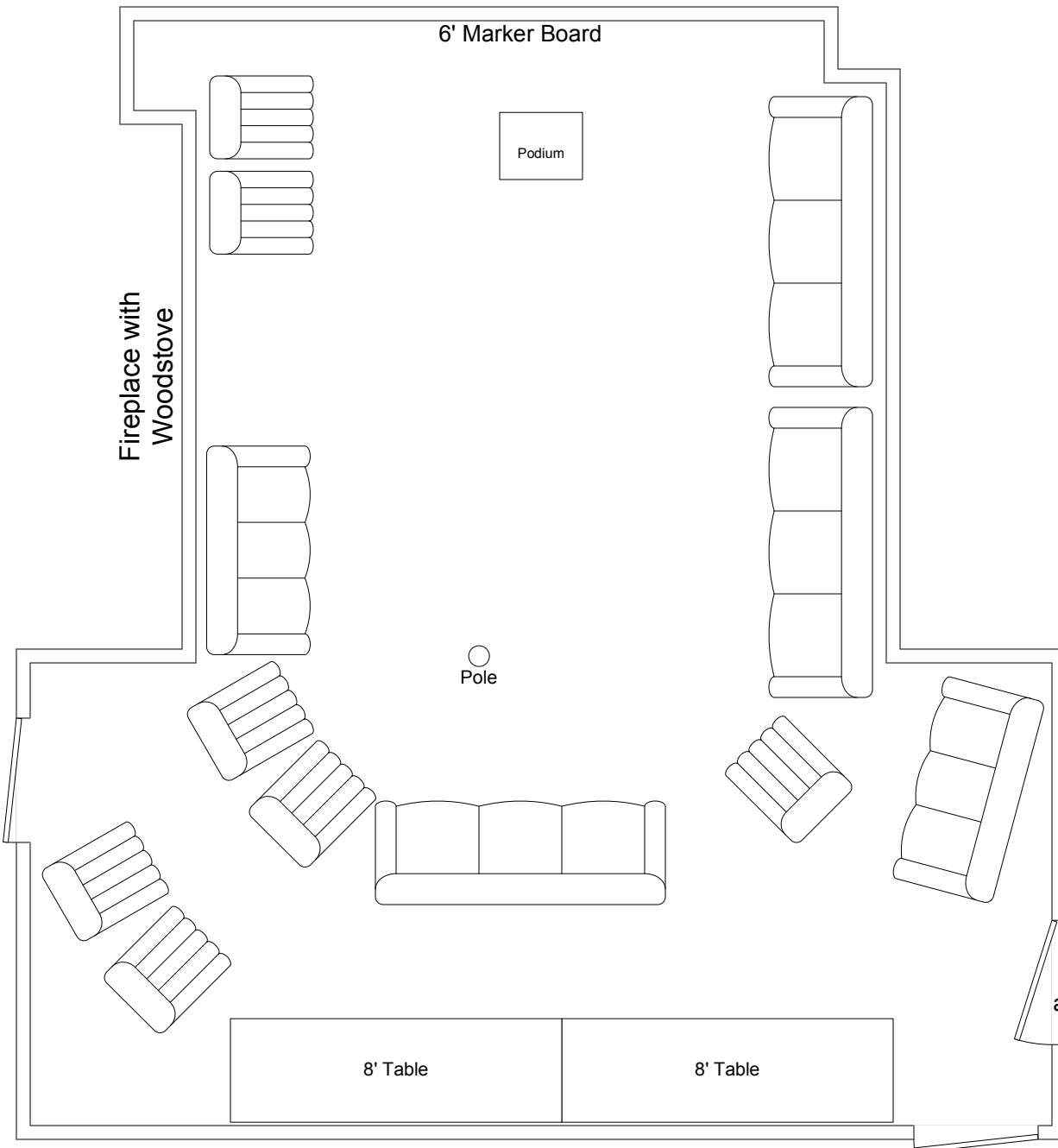
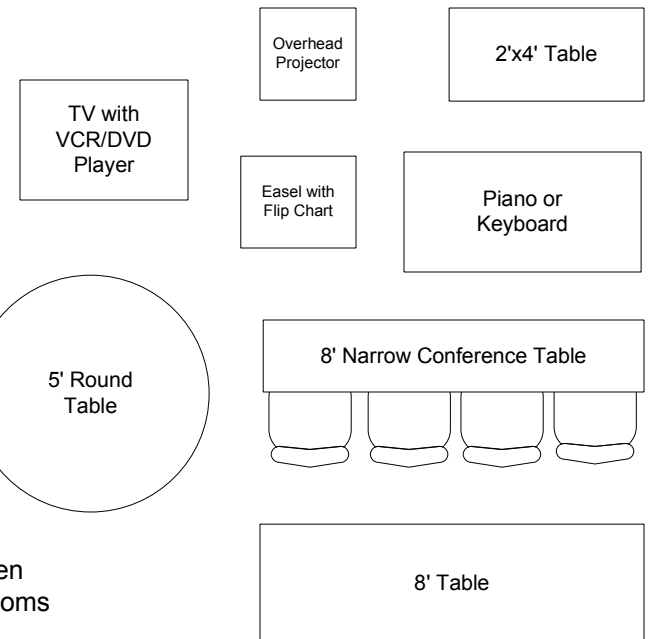

Scale - 1/4" = 1'

Rhododendron Meeting Room

17' / 25' X 27' with 8' ceiling

Open Room

Bulletin strips on one side & front walls
 Bulletin board on back wall
 6' Projection Screen hung front center only

Portable PA System Available
 CD/Tape Player/Recorder Available
 Maximum of 4 mikes / inputs

Other Set Up Equipment Available

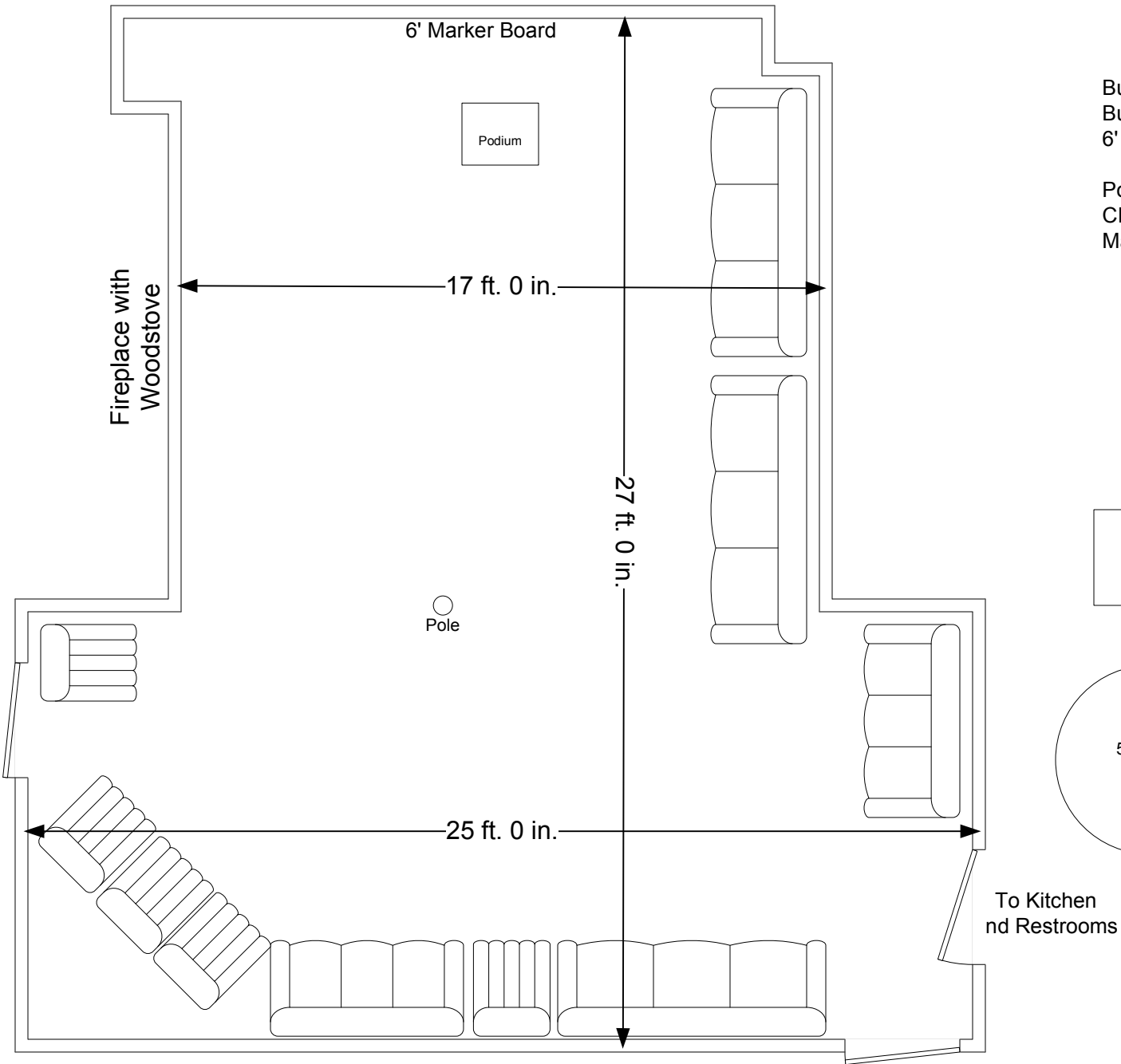
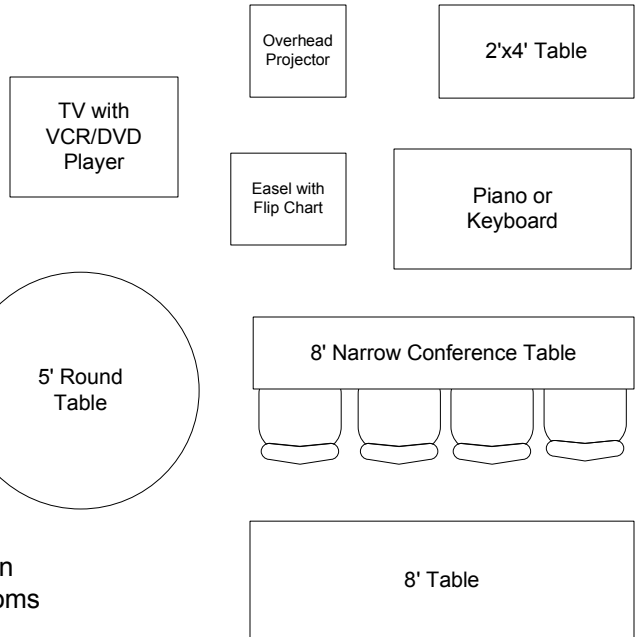

Scale - 1/4" = 1'

Rhododendron Meeting Room

17'25" X 27' with 8' ceiling

Maximum Seating - 48
No Tables in Room

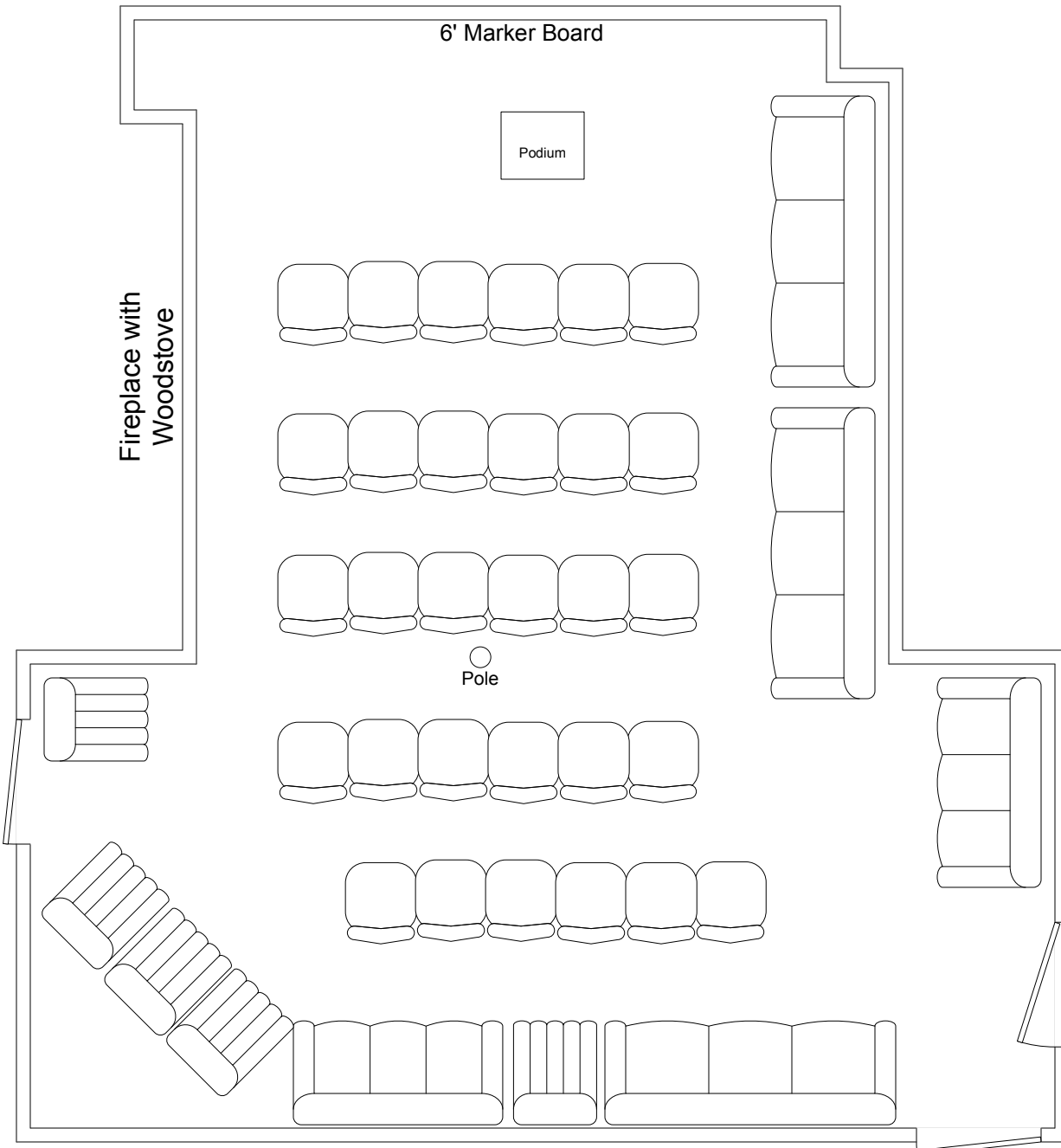

Bulletin strips on one side & front walls
Bulletin board on back wall
6' Projection Screen hung front center only

Portable PA System Available
CD/Tape Player/Recorder Available
Maximum of 4 mikes / inputs

Other Set Up Equipment Available

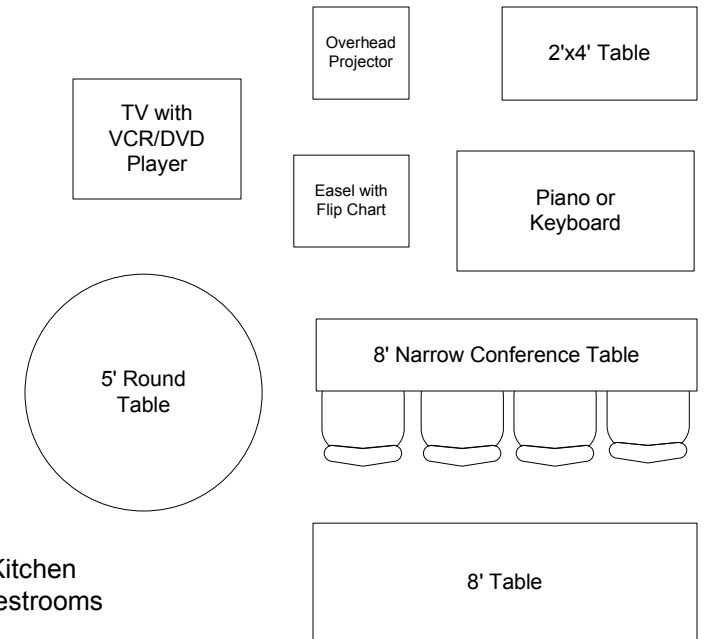

To Kitchen
and Restrooms

Scale - 1/4" = 1'

Rhododendron Meeting Room

17' / 25' X 27' with 8' ceiling

Conference Style Seating for 12 behind narrow tables

Bulletin strips on one side & front walls
 Bulletin board on back wall
 6' Projection Screen hung front center only

Portable PA System Available
 CD/Tape Player/Recorder Available
 Maximum of 4 mikes / inputs

Other Set Up Equipment Available

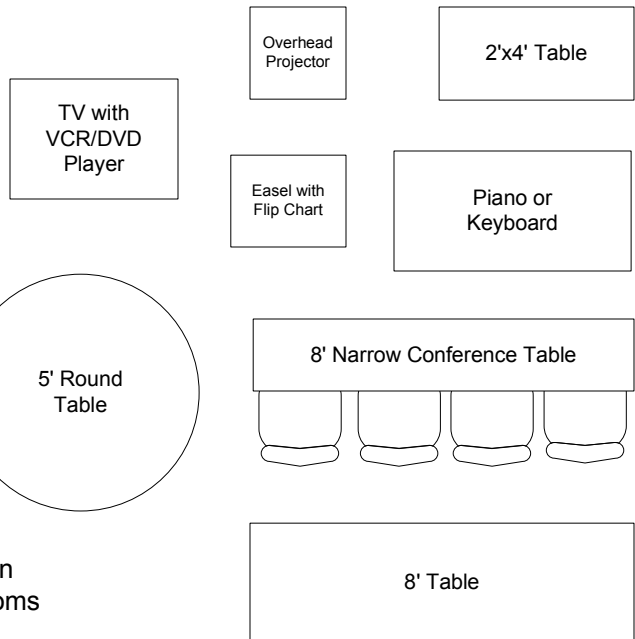

Scale - 1/4" = 1'

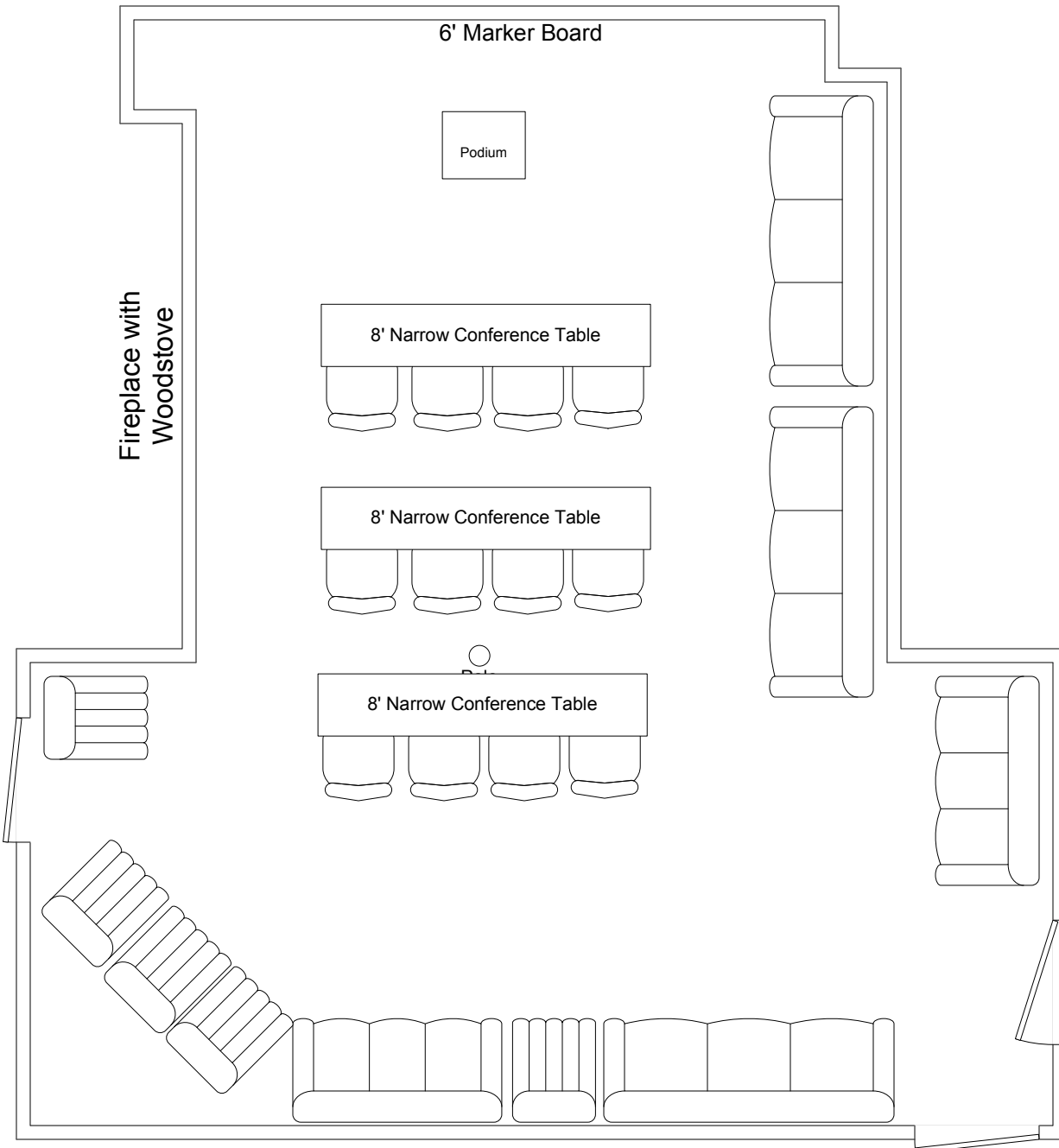

Rhododendron Meeting Room

17'25" X 27' with 8' ceiling

Open Board Style
Seating for 14
behind 30" tables

Bulletin strips on one side & front walls
Bulletin board on back wall
6' Projection Screen hung front center only

Portable PA System Available
CD/Tape Player/Recorder Available
Maximum of 4 mikes / inputs

Other Set Up Equipment Available

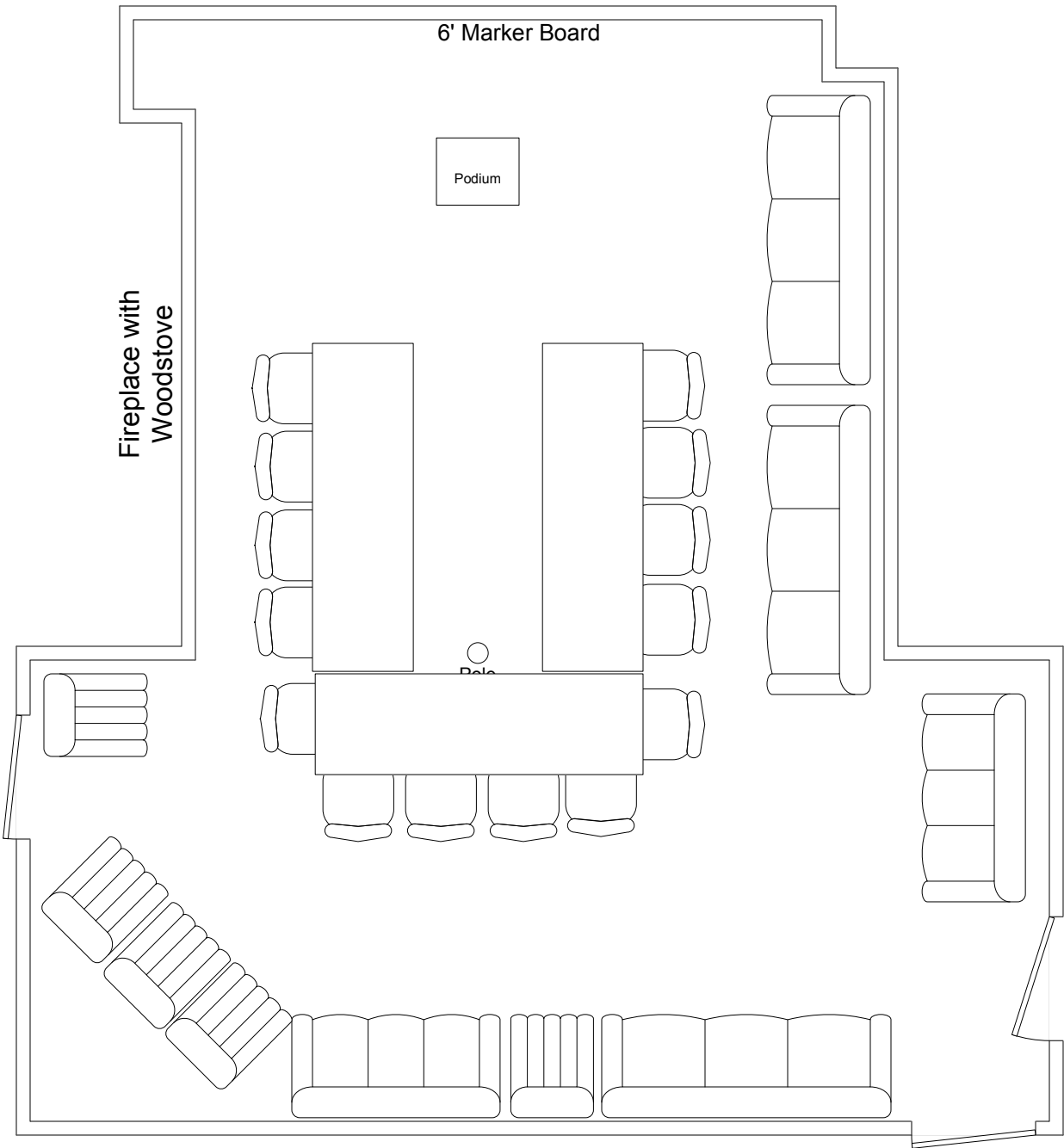
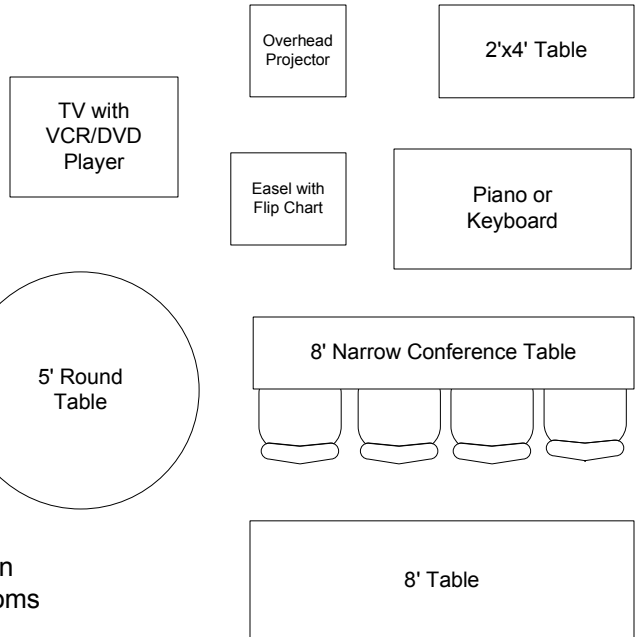

Scale - 1/4" = 1'

Rhododendron Meeting Room

17'25" X 27' with 8' ceiling

Closed Board Style
Seating for 20
behind 30" tables

Bulletin strips on one side & front walls
Bulletin board on back wall
6' Projection Screen hung front center only

Portable PA System Available
CD/Tape Player/Recorder Available
Maximum of 4 mikes / inputs

Other Set Up Equipment Available

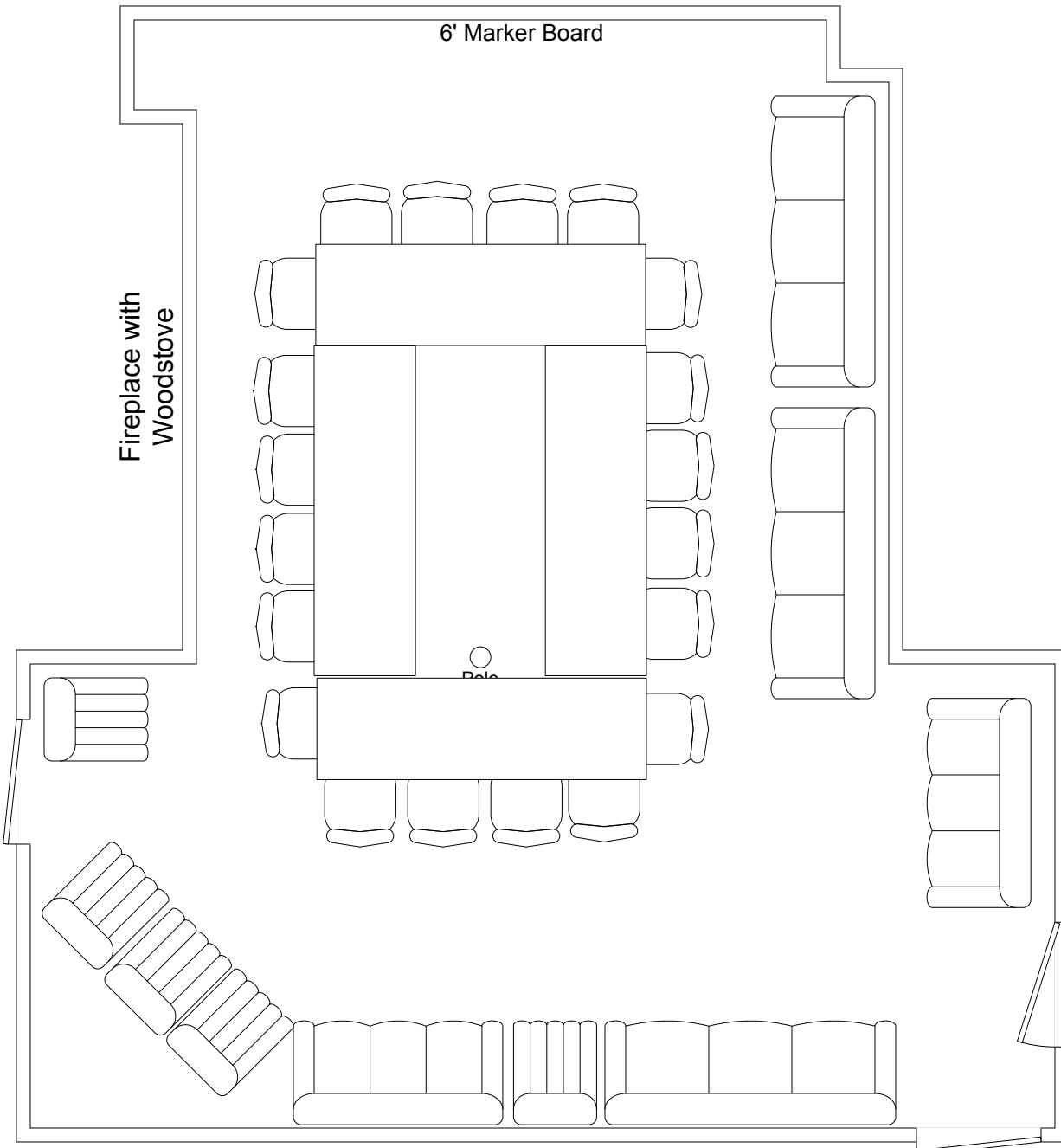
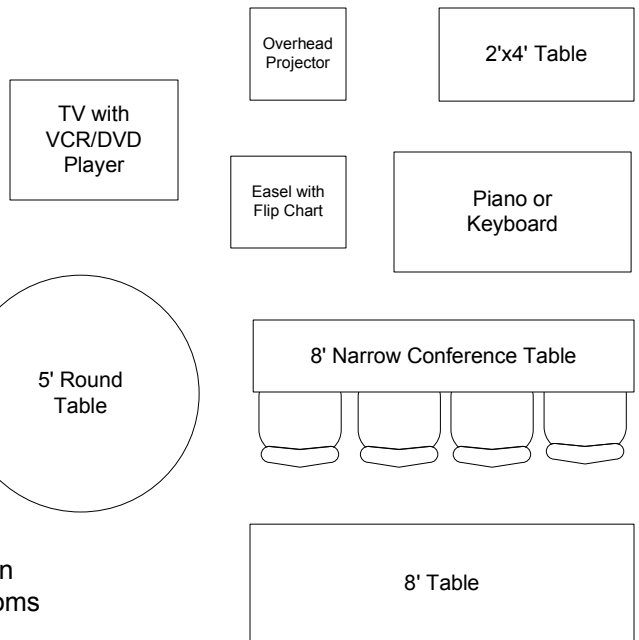

Scale - 1/4" = 1'